



Instructions
Gebrauchsanleitung
Instrucciones
Instruizione

PT100



pH (Phenol Red)
Chlorine / Bromine
(DPD1 / DPD3)

PT500



pH (Phenol Red)
Cl / Br (DPD1 / 3)
Alk (Alkatest)

PTM100



pH (Phenol Red)
Chlorine / Bromine
(DPD1 / DPD3)

WATER TESTING
MADE IN GERMANY

Reagents
Reagenzien
Réactifs
Reactivos
Reagenti



PT100 / PTM100:

DPD 1 RAPID (free chlorine)
Phenol Red RAPID (pH)
*DPD 3 RAPID (total chlorine)
*optional!

Refill-Pack:

TbsRD1pH60
30 x Phenol Red RAPID
30 x DPD 1 RAPID

Optional
TbsRD350
50 x DPD 3 RAPID

PT500

DPD 1 RAPID (free chlorine)
Phenol Red RAPID (pH)
Alkatest RAPID (Alkalinity)
*DPD 3 RAPID (total chlorine)
*optional!

Refill-Pack:

TbsRD1pHAL60
20 x Phenol Red RAPID
20 x DPD 1 RAPID
20 x Alkatest RAPID

Optional
TbsRD350
50 x DPD 3 RAPID

(GB)

CAUTION!

Reagents for water-analysis only!
Do not eat! Keep away from children!
Store cool and dry!
Clean tester properly before testing!

(F)

Attention!

Les pastilles sont exclusivement destinées aux analyses chimiques. NE PAS AVALER. Tenir hors de portée des enfants. Conserver dans un endroit frais et sec. Bien rincer le testeur avant chaque utilisation!

(E)

¡Atención!

Pastillas para el análisis de aguas, solamente para análisis químicos!
No para tomar!
No debe llegar a las manos de niños!
Consérvese en lugar fresco y seco!
Limpiar el aparato antes de usar!

(I)

Attenzione!

Reagenti unicamente per analisi acqua!
Non ingerire!
Tenere fuori dalla portata dei bambini!
Mantenere in luogo asciutto e fresco
Dopo l'utilizzo pulire ed asciugare accuratamente il tester.

(P)

Atenção!

Comprimidos para análise de água, apenas para a análise química!
Não para tomar!
Não deve chegar às mãos de crianças!
Mantenha em local fresco e seco!
Limpar o aparelho antes de usar!



1



2

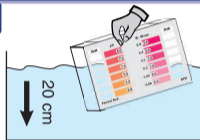

3

PT500
1 x Alkatest

Phenol Red
1 x

DPD 1 (DPD3)
1 x

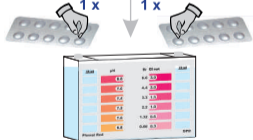

Free Cl = 1 x DPD 1

Total Cl = 1x DPD 1 + 1 x DPD 3*

plus 2 Min.

Combined Cl = Total Cl - Free Cl

*optional

4

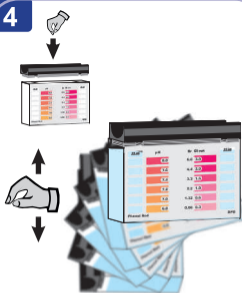

6



clean properly



no detergent!



5

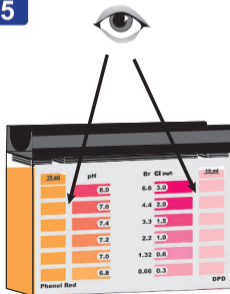

!!! Important !!!

Very high chlorine levels
will bleach out the DPD reagent
and lead to colorless solution!

DPD RAPID tablets
leave a white residue
on the bottom of the tester.
This is normal and does not
interfere with the measurement

PT500 / Alkalinity:

conversion of Alkalinity to:

$K_{S,4.3}$ mmol/l (x 0.02)

°dH (x 0.056)

°eH (x 0.07)

°fH (x 0.1)